

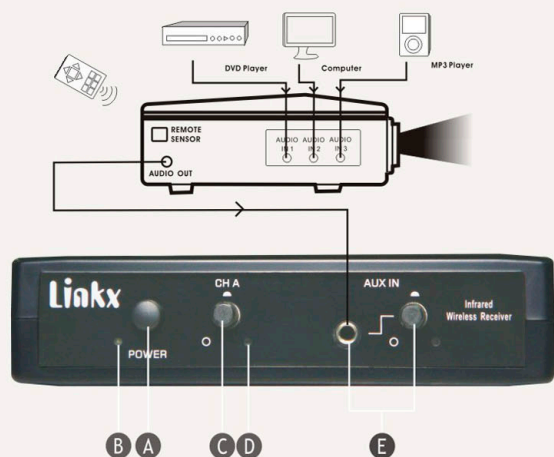



# IRA-100 Single Channel Infrared Soundfield System

The IRA-100 sound system is an essential complement to the interactive whiteboard system: Whiteboard for visual, IRA-100 to reinforce the instructor's voice and amplify media sources. The system features a single-channel wireless microphone receiver with a 20 watt amplifier to power two or four speakers. With an IRA-100 infrared wireless microphone system, the teacher's voice will be clearly heard throughout the room with ease. And the auxiliary input on the front panel allows the input of an iPod™, computer, or DVD to supplement the instructional program.



- |   |                              |
|---|------------------------------|
| <b>A</b> Power switch                       | <b>E</b> AUX IN              |
| <b>B</b> Power Indicator                    | <b>F</b> Speaker Output      |
| <b>C</b> Infrared Microphone Volume Control | <b>G</b> Sensor Inputs (RCA) |
| <b>D</b> IR Indicator                       | <b>H</b> DC IN (12V)         |

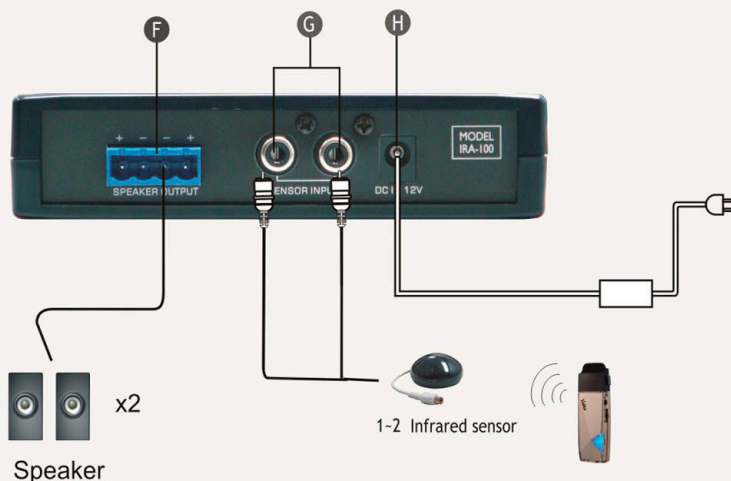

## System includes:

- IRA-100 system: IRA-100 Receiver Amplifier\*1, Pendant transmitter T6\*1 Infrared Sensor \*1



## T6 Infrared Pendant Transmitter "Diamond"

T6 vocal clarity is unsurpassed. It boasts high level output, reliable connectivity and exceptional definition. With a built-in breath filter, T6 can function as a pass-around hand mic. With a tap on the power button, the mic mutes for private conversation - tap again to restore to normal operation. The auxiliary input allows wireless playback of your iPod™ through the T6. A three-position slide switch provides selection of low, med, or high microphone volume level.

## Features:

- Extremely lightweight, only 39g with battery
- Detachable clip and safety breakaway lanyard
- Push on/off and mute button with functional LED indicator
- Three position slide switch provides selection of low-mid-hi microphone volume level
- Hidden channel " 1-A, 2-B, 3(Push to talk)-B " selector
- External mic and aux input jack (3.5mm)
- Built-in Li-polymer battery
- Micro USB charging capability

## IRM-202AB Infrared Handheld Microphone

The handheld microphone/transmitter is primarily used by students for interactive class participation. The ergonomic design renders user comfort and very low handling noise, The unidirectional condenser microphone reproduces excellent vocal quality and the windscreen prevents breath pops. The emitting diodes are located around the top and bottom ends of the holder for 360° transmission and assured connectivity throughout the classroom

## Features:

- Emitters are located around the top and bottom to prevent transmitting interruption from hand inadvertently blocking
- Transmitter with condenser mic element
- Power on/off switch
- Rechargeable NiMH batteries
- Battery level indicator-LED

## IRS-55 Infrared Ceiling Sensor



- Reception area: 232m<sup>2</sup> / 2500ft<sup>2</sup>
- Operating range: 15m radius to central of sensor
- LED Power Indicator
- Phantom Powered by Receiver / Amplifier
- 15m cable. RCA type
- Ceiling mount rack

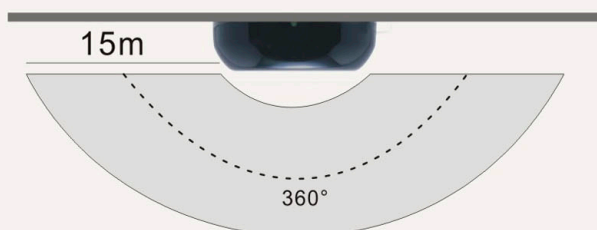

# IRA-89 2-Channel Infrared Soundfield System

The IRA-89 is a complete sound-field system for installation in a classroom or similar environment. It allows simultaneous use of two infrared wireless microphones and multimedia integration. The nucleus of the system is the powerful amplifier with two infrared receivers, page pass through, and four auxiliary inputs for Computer, DVD, Video Projector, and VCR. Trouble-free infrared wireless communication is secure and free from outside interference (will not transmit through walls).

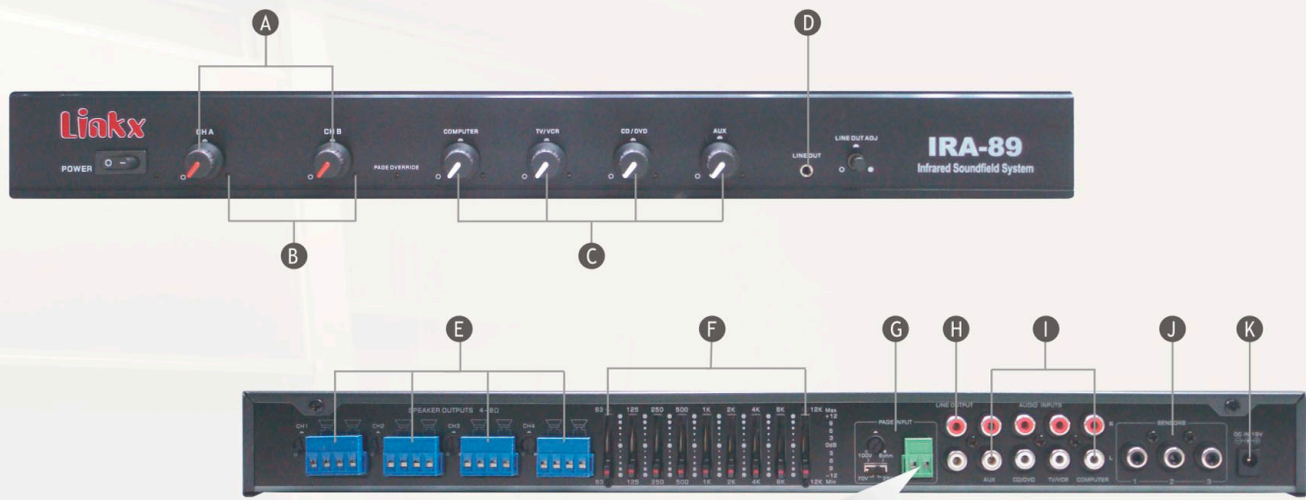

## Advanced Feature Page Override School PA System

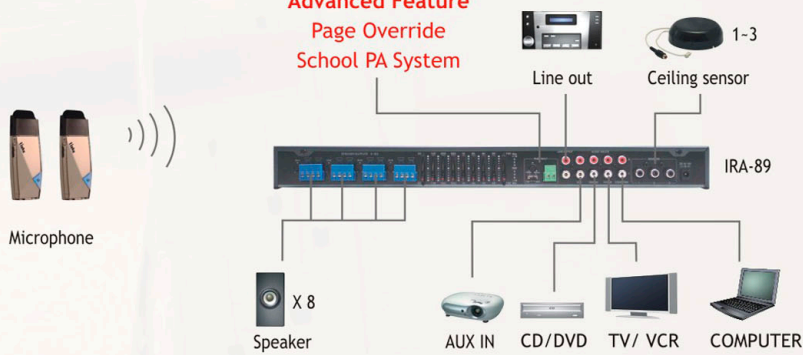

- |                                      |                            |
|--------------------------------------|----------------------------|
| Ⓐ Microphone Volume Control          | Ⓑ IR Indicator             |
| Ⓒ Auxiliary Volume Control           | Ⓓ Front Panel Line Output  |
| Ⓔ Speaker Outputs and Level Controls | Ⓕ Nine-Band Equalizer      |
| Ⓖ Page Input with Override Priority  | Ⓗ Rear Panel Line Output   |
| Ⓘ Audio Inputs                       | Ⓙ 3-External Sensor Inputs |
| Ⓚ DC Input                           |                            |

### Features:

- Four Power Amplifier: 22.5watts ea. with individual gain controls
- Powers up to eight 8Ω speakers
- Two infrared wireless microphone receivers
- Four Stereo Line Level Auxiliary Inputs
- Front Panel Audio Output for personal FM system with gain control (3.5mm)
- Nine Band Equalizer for extra fine acoustic tuning
- Page Over-ride(muting) with Page Pass-through to classroom speakers
- Rear line level output (pre-fader) for recording with an active board for internet podcasts
- Rack or shelf/wall mount kits (optional)

### System includes:

- IRA-89 system: IRA-89 Receiver Amplifier\*1, Pendant transmitter T6\*2  
Ceiling Sensor \*1

### Optional Microphones





## IRA-100 Mini Single Channel Infrared Receiver Amplifier

Carrier Reception	Infrared
Reception System	Heterodyne
No. of Channel	1
Reception Frequencies	CH A: 2.08MHz
Infrared Wavelength	850nm
Modulation System	FM Wide-Band
Tone Signal	32.768KHz
De-emphasis	50 $\mu$ S
Frequency Response	40Hz-17KHz $\pm$ 3dB
S/N Ratio	> 70dB
THD	< 1.0% (at 1KHz)
Max. Deviation	$\pm$ 22.5KHz
External Sensor Inputs	2
Outputs	Amplifier Output(Two Amp) 20W total 10W ea. Into 4 $\Omega$ load Terminal Block(Dual 2-pin)
Power supply used	DC 12V/ 2A
Enclosure Material	ABS
Size	130(W) $\times$ 118(D) $\times$ 30.9(H)mm
Weight	195 g

## T6 Infrared Pendant Transmitter

Type	Pendant
Infrared Ray Wavelength	850 nm
Transmission Frequency	1- channel A : 2.08 MHz / 2- channel B: 2.54 MHz / 3- channel B: 2.54 MHz ( push to talk )
Modulation	FM
Pilotone Frequency	32.768KHz
Transmission Angle	180 $^\circ$ , Conical
Microphone Capsule	Condenser, Unidirectional
Location of IR Emitter	Built-in, Top
Power Switch	On / Off / Mute Push Button
Volume Control	HIGH / MIDDLE / LOW Switch
External Aux Input	One 3.5mm Stereo Jack for line or Mic input
Function Control Switch	Aux Input Volume Up - Thumb Rotary Up Aux Input Volume Down - Thumb Rotary Down
Push to Talk	Switch to CH 3 - channel B, Press and hold the Function Control Switch to Talk
Current Consumption	90mA
Battery Used	Linkx Li-Polymer Battery (3.7V / 600mAh)
Battery Life	Approx. 7 hours
Power LED Indicator	ON = Blue Mute = Flashing Blue Battery Capacity = Full to Low (Blue ->Purple ->Red) Flashing Red = Battery Low, Needs Charging Push to Talk (on CH 3-channel B) = Green Charging = RED Charging complete = Green
External Power Charge	DC+5V , Micro USB connector Charging source is compatible from any laptop, PC or provided travel adaptor
Clip and Lanyard	Clip and Adjustable neck strap with break away clip
Dimensions	19mm(Thickness) $\times$ 93 mm(H) $\times$ 30.6 mm(W)
Weight	Approx. 39 g ( with Battery)

### T6 Accessories



USB to MicroUSB  
cable



USB power  
adaptor



Detachable  
Clip



Lanyard

# Linkx

LINKX ELECTRONICS CO., LTD.

4F-1, No.332 Ming-Chen 2nd Road, Tsou-In Dist., Kaohsiung Taiwan

t: +886-7-558-0746 f: +886-7-558-0741

info@linkx.com.tw www.linkx.com.tw

All rights reserved. Do not copy or forward without prior Linkx approvals.  
Specifications and design subject to change without notice.

## IRA-89 2-Channel Infrared Receiver Amplifier Receiver

Carrier Reception	Infrared
Reception System	Heterodyne
No. of Channel	2
Frequency	CH A : 2.08 MHz / CH B : 2.54 MHz
Infrared Wavelength	850 nm
Modulation	FM Wide-Band
De-emphasis	50 $\mu$ S
Nominal Deviation	$\pm$ 10KHz
Maximum Deviation	$\pm$ 25KHz
External Sensor Inputs	3, RCA type.

### Amplifier

Amplifier Output	(Four Amp) 90W total 22.5W ea. into 4-8 $\Omega$ load, Terminal block connectors
Equalizer	9 Band, $\pm$ 12dB
Aux Inputs	4 Terminals, Aux, CD/DVD, TV/VCR, computers with Twin RCA connectors
Front Panel Output	3.5mm phone jack
Rear Panel Output	Twin RCA connector
Page Input	Speaker Level: 8ohm, 25, 70, 100v
Page Pass Through	Switchable w/ gain control
Frequency Response	50Hz -15KHz, $\pm$ 3dB
S/N Ratio	>70dB
THD	< 1%@1KHz
Power Supply	DC 19V / 4.73A
Size	430(W) $\times$ 215(D) $\times$ 44(H)mm
Weight	Approx. 2.35 kgs

## IRM-202AB Infrared Handheld Microphone

Type	Handheld
Transmission Frequency	CH A : 2.08 MHz / CH B : 2.54 MHz (Switchable)
Modulation	FM
Pilotone Frequency	32.768 KHz (A / B CH)
Transmission Angle	360 $^\circ$
Location of IR Emitter	Two locations, Top and bottom of Tubular
Power Switch	On/Off Slide
Microphone Capsule	Condenser, Unidirectional
Current Consumption	220 mA
Battery Used	Dual "AA" NiMH Rechargeable
Battery Life	Approx. 9 hours
Battery LED	Green - Usable, Red - Needs Charging
Dimensions	247(L) $\times$ 45(dim.) mm
Weight	240 g

### IRM-202 Accessories



Tube



Rechargeable  
Battery

## IRS-55 Infrared Ceiling Sensor

Operating Frequency	2MHz to 2.8 MHz
Operating Range	15m radius to central of sensor
Signal / Power Interface	Female RCA
Reception Area	232m <sup>2</sup> / 2500ft <sup>2</sup>
Power Indicator LED	Green
Reception Angle	360 $^\circ$ full semi-spherical(half dome) coverage
Dimensions	118(DIA) $\times$ 35(H) mm
Weight	210 g

### IRS-55 Accessories



Ceiling Bracket



15m Cable